

FASTENERS
for

PLASTIC

specialised
fasteners for
the use with
plastic



HARRISON
SILVERDALE LTD
INNOVATIVE FASTENERS

making the **right** connection



HARRISON SILVERDALE LTD INNOVATIVE FASTENERS

making the **right** connection

Harrison Silverdale have been supplying Industrial Fasteners since 1982. Over the years we have gained an enviable reputation for quality and reliability serving leading OEM's and distributors across Europe.

Our core products are fasteners for plastics and sheet metal. We also have a design service for special parts which is covered by our ISO 9001-2015 certification.

Our extensive range, engineering expertise and product knowledge means we are best placed to provide a cost effective supply solution for your fastener requirements.

Call our sales office or visit our website to find out more.

+44 (0) 1246 296 930 www.harrisonsilverdale.com

Contents

Fasteners for Plastic

Series No	Description	Page
Press Fit Inserts		
20103 FL & HFL	Press Fit & Headed (Thermoplastic)	4
20103 MS	Press Fit (Thermoplastic)	5
20104 PI	Press Fit Inserts (Thermoset)	6
20104 HPI	Headed Press Fit (Thermoset)	7
Screw Fit Inserts		
20105 SC	Screw Fit (Plastic, Alloy & Composite)	8
20105 TC	Screw Fit (Plastic, Alloy & Composite)	9
20130 D	Headed Screw Fit (Soft Thermoplastic)	10
20131 E	Screw Fit (Soft Thermoplastic)	11
Heat / Ultrasonic Fit Inserts		
20106 IS	Heat / Ultrasonic Fit (Thermoplastic)	12
20106 HIS	Headed Heat / Ultrasonic Fit (Thermoplastic)	13
20108 HL	Heat Fit (Brittle Thermoplastic)	14
20108 TC	Heat Fit Double Ended (Thermoplastic)	15
Over Moulding Inserts		
20109 DNT	Moldcert Round Through Thread (Over Moulding)	16
20109 FT	Moldcert Round Blind Thread (Over Moulding)	17
20109 HXT - HXB	Moldcert Hex Blind / Thro Thread (Over Moulding)	18
Expansion Inserts		
20110 DMK	Expansion Fit (Thermoset)	19
20110 DMR	Reverse Headed Expansion Fit (Thermoset)	20
20110 HDM	Headed Expansion Fit (Thermoset)	21
20110 PL	Press Fit Expansion (Thermoplastic)	22
Insert Studs		
20106 ISS	Heat / Ultrasonic Stud (Thermoplastic)	23
20106 HSS	Headed Heat / Ultrasonic Stud (Thermoplastic)	24
Thread Forming Screws		
20210	Polyplast30 Screws PZ Drive	25
20210	Polyplast30 Screws TX Drive	26
Rivet Nuts		
30234 PN	PN Rivet Nuts (Thin Sheet Materials)	27
30235 JK	JK Rivet Nuts (Thin Sheet Materials)	28
Chimney & Lug Nuts		
40114/40118	Chimney & Lug Nuts	29
Tooling		
14001 HS	HS1000 Heat Staking Machine	30

Press Fit (Thermoplastic)

Series: 20103 Type: FL

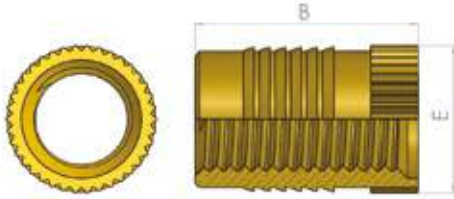

Part No	Thread	E	B	Hole +0.1	Min Wall
FL020H040	M2	3.7	4.0	3.2	1.6
FL025H048	M2.5	4.5	4.8	4.0	2.0
FL030H048	M3	4.5	4.8	4.0	2.0
FL035H064	M3.5	5.3	6.4	4.8	2.4
FL040H079	M4	6.1	7.9	5.6	2.8
FL050H095	M5	7.0	9.5	6.4	3.2
FL060H127	M6	8.6	12.7	8.0	4.0
FL080H127	M8	10.2	12.7	9.6	4.8

Headed Press Fit (Thermoplastic)

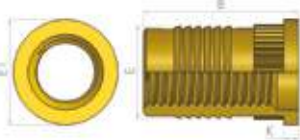

Series: 20103
Type: HFL



Part No	Thread	E	E1	B	K	Hole +0.1	Min Wall
HFL020H044	M2	3.7	4.8	4.4	0.45	3.2	1.6
HFL025H053	M2.5	4.5	5.5	5.3	0.58	4.0	2.0
HFL030H053	M3	4.5	5.5	5.3	0.58	4.0	2.0
HFL035H071	M3.5	5.3	6.4	7.1	0.74	4.8	2.4
HFL040H088	M4	6.1	7.1	8.8	0.89	5.6	2.8
HFL050H106	M5	7.0	7.9	10.6	1.07	6.4	3.2
HFL060H140	M6	8.6	9.5	14.0	1.32	8.0	4.0
HFL080H140	M8	10.2	11.1	14.0	1.32	9.6	4.8

The FL and HFL range of inserts are designed for cold press fitting into thermoplastic. The combination of knurls and ribs on the body provide high torque and pull out performance.

The headed HFL increases jack-out and pull through performance.

Material: Brass

Information is for guidance only and subject to change.

Press Fit (Thermoplastic)

Series: 20103 Type: MS

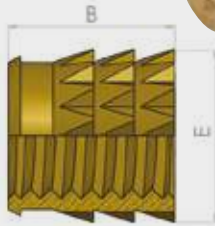

Information is for guidance only and subject to change.

Part No	Thread	E	B	Hole Dia	Min Wall
MSO20H031	M2	3.5	3.1	3.0 - 3.3	1.4
MSO20H042	M2	3.5	4.2	3.0 - 3.3	1.4
MSO25H041	M2.5	4.3	4.1	3.7 - 4.0	1.7
MSO25H052	M2.5	4.3	5.2	3.7 - 4.0	1.7
MSO30H041	M3	4.3	4.1	3.7 - 4.0	1.7
MSO30H052	M3	4.3	5.2	3.7 - 4.0	1.7
MSO35H041	M3.5	5.3	4.1	4.6 - 5.0	2.2
MSO35H070	M3.5	5.3	7.0	4.6 - 5.0	2.2
MSO40H056	M4	6.3	5.6	5.4 - 5.9	2.5
MSO40H085	M4	6.3	8.5	5.4 - 5.9	2.5
MSO50H066	M5	7.05	6.6	6.0 - 6.5	2.9
MSO50H101	M5	7.05	10.1	6.0 - 6.5	2.9
MSO60H077	M6	8.65	7.7	7.7 - 8.2	3.2
MSO60H123	M6	8.65	12.3	7.7 - 8.2	3.2
MSO80H083	M8	11.0	8.3	10.2 - 10.6	4.2
MSO80H138	M8	11.0	13.8	10.2 - 10.6	4.2

Type MS inserts have a coarse knurl pattern making them ideal for all types of thermoplastic. They can be inserted by heat, ultrasonic press or simply pressing into the boss.

Material: Brass

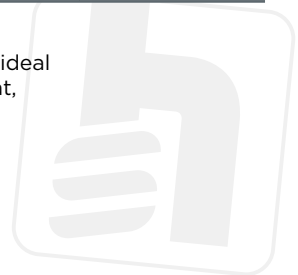

Press Fit Inserts (Thermoset)

Series: 20104 Type: PI

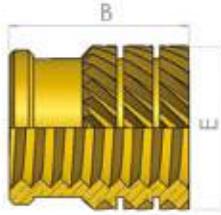

Information is for guidance only and subject to change.

Part No	Thread	E	B	Hole Dia	Min Wall
PI020H040	M2	3.3	4.0	3.1	1.6
PI025H053	M2.5	4.2	5.3	3.8	2.0
PI030H053	M3	4.2	5.3	3.8	2.0
PI035H063	M3.5	5.0	6.3	4.6	2.5
PI040H074	M4	5.8	7.4	5.4	2.5
PI050H083	M5	6.6	8.3	6.2	2.5
PI060H092	M6	8.2	9.2	7.8	2.8
PI080H092	M8	9.7	9.2	9.3	3.8
PI100H092	M10	12.0	9.2	11.6	5.5

Type PI insert is designed to provide permanent, strong, reusable free running thread forms in Thermoset and other hard plastics. The three bands of sharp helical knurling ensure the insert broaches its way into the plastic whilst the debris packs the relief to ensure the insert locks in place providing high resistance to torque and pull out loads.

Material: Brass

Headed Press Fit (Thermoset)

Series: 20104 Type: HPI

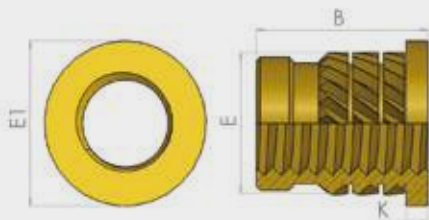

Information is for guidance only and subject to change.

Part No	Thread A	E	E1	K	B	Hole Dia	Min Wall
HPI020H046	M2	3.3	4.8	0.6	4.6	3.1	1.6
HPI025H059	M2.5	4.2	5.6	0.6	5.9	3.8	2.0
HPI030H059	M3	4.2	5.6	0.6	5.9	3.8	2.0
HPI035H071	M3.5	5.0	6.4	0.8	7.1	4.6	2.5
HPI040H082	M4	5.8	7.2	0.8	8.2	5.4	2.5
HPI050H093	M5	6.6	8.0	1.0	9.3	6.2	2.5
HPI060H105	M6	8.2	9.5	1.3	10.5	7.8	2.8
HPI080H105	M8	9.7	11.0	1.3	10.5	9.3	3.8
HPI100H105	M10	12.0	14.2	1.6	10.8	12.3	5.0

Type HPI insert is designed to provide permanent, strong, reusable free running thread forms in Thermoset and other hard plastics. The three bands of sharp helical knurling ensure the insert broaches its way into the plastic whilst the debris packs the relief to ensure the insert locks in place providing high resistance to torque and pull out loads. The head provides a surface bearing area to resist jack out or pull through loads.

Material: Brass



Screw Fit (Plastic, Alloy & Composite)

Series: 20105 Type: SC

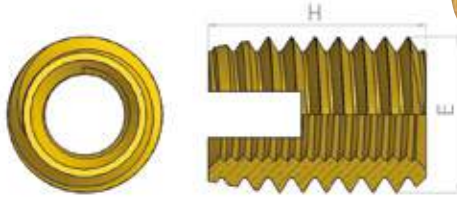

Information is for guidance only and subject to change.

Part No	Thread	E	H	Hole Soft	Hole Hard	Hole Depth
SC025H04_	M2.5	4.0	4.0	3.7-3.8	3.8-3.9	5.0
SC025H06_	M2.5	4.5	6.0	4.0-4.1	4.1-4.2	8.0
SC030H05_	M3	5.0	5.0	4.7-4.8	4.8-4.9	7.0
SC030H06_	M3	5.0	6.0	4.5-4.6	4.6-4.7	8.0
SC035H06_	M3.5	6.0	6.0	5.3-5.4	5.5-5.6	8.0
SC035H08_	M3.5	6.0	8.0	5.3-5.4	5.5-5.6	10.0
SC040H07_	M4	6.5	7.0	5.8-5.9	6.0-6.1	9.0
SC040H08_	M4	6.5	8.0	5.8-5.9	6.0-6.1	10.0
SC050H08_	M5	8.0	8.0	7.1-7.2	7.3-7.5	10.0
SC050H10_	M5	8.0	10.0	7.1-7.2	7.3-7.5	13.0
SC060H10_	M6	9.0	10.0	8.1-8.2	8.3-8.5	12.0
SC060H12_	M6(A)	9.0	12.0	8.1-8.2	8.3-8.5	15.0
SC060H14_	M6	10.0	14.0	8.6-8.8	8.9-9.2	17.0
SC080H13_	M8	12.0	13.0	10.6-10.8	10.9-11.2	16.0
SC080H15_	M8	12.0	15.0	10.6-10.8	10.9-11.2	18.0
SC100H16_	M10	14.0	16.0	12.6-12.8	12.9-13.2	19.0
SC100H18_	M10	14.0	18.0	12.6-12.8	12.9-13.2	22.0
SC120H22_	M12	16.0	22.0	14.6-14.8	14.9-15.2	26.0
SC140H24_	M14	18.0	24.0	16.6-16.8	16.9-17.2	28.0
SC160H22_	M16	20.0	22.0	18.6-18.8	18.9-19.2	27.0
SC180H24_	M18	22.0	24.0	20.6-20.8	20.9-21.2	29.0
SC200H27_	M20	26.0	27.0	24.6-24.8	24.9-25.2	32.0
SC220H30_	M22	26.0	30.0	24.6-24.8	24.9-25.2	36.0
SC240H30_	M24	30.0	30.0	28.6-28.8	28.9-29.2	36.0
SC270H30_	M27	34.0	30.0	32.6-32.8	32.9-33.2	36.0
SC300H40_	M30	36.0	40.0	34.6-34.8	34.9-35.2	46.0

The SC inserts are available in a wide range of sizes and materials to suit many applications. The slotted, leading end helps to break away swarf during the tapping / insertion process.

Material: Brass code BR for use in plastic
Case Hardened Steel code CH for use in alloys
303 Stainless Steel code SS for corrosion resistance

To specify use Series/Part No/Material Code e.g. 20105 SC060H14BR

Screw Fit (Plastic, Alloy & Composite)

Series: 20105 Type: TC

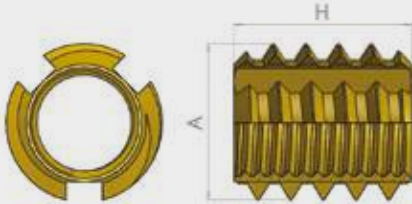

Information is for guidance only and subject to change.

Part No	Thread	H	A	Hole Dia	Wall Min	Hole Depth Min	Style
TC020H040	M2	4.00	3.50	3.10	1.20	4.40	SHORT
TC020H048	M2	4.80	3.50	3.10	1.20	5.30	STANDARD
TC020H053	M2	5.25	3.50	3.10	1.20	5.80	LONG
TC025H040	M2.5	4.00	4.33	3.80	1.45	4.40	SHORT
TC025H053	M2.5	5.25	4.33	3.80	1.45	5.80	STANDARD
TC025H063	M2.5	6.25	4.33	3.80	1.45	6.90	LONG
TC030H040	M3	4.00	4.73	4.10	1.55	4.40	SHORT
TC030H053	M3	5.25	4.73	4.10	1.55	5.80	STANDARD
TC030H063	M3	6.25	4.73	4.10	1.55	6.90	LONG
TC035H050	M3.5	5.00	5.52	5.00	1.90	5.50	SHORT
TC035H062	M3.5	6.20	5.52	5.00	1.90	6.90	STANDARD
TC035H073	M3.5	7.30	5.52	5.00	1.90	8.10	LONG
TC040H056	M4	5.60	6.31	5.80	2.20	6.20	SHORT
TC040H071	M4	7.10	6.31	5.80	2.20	7.80	STANDARD
TC040H084	M4	8.40	6.31	5.80	2.20	9.30	LONG
TC050H064	M5	6.40	7.50	6.90	2.60	7.10	SHORT
TC050H084	M5	8.40	7.50	6.90	2.60	9.30	STANDARD
TC050H100	M5	10.0	7.50	6.90	2.60	11.0	LONG
TC060H079	M6	7.90	8.69	8.00	3.00	8.70	SHORT
TC060H098	M6	9.80	8.69	8.00	3.00	10.8	STANDARD
TC060H120	M6	12.0	8.69	8.00	3.00	13.2	LONG
TC080H095	M8	9.50	11.06	10.1	3.80	10.5	SHORT
TC080H124	M8	12.4	11.06	10.1	3.80	13.7	STANDARD
TC080H150	M8	15.0	11.06	10.1	3.80	16.5	LONG
TC100H120	M10	12.0	13.95	13.0	4.90	13.2	SHORT
TC100H160	M10	16.0	13.95	13.0	4.90	17.6	STANDARD
TC100H180	M10	18.0	13.95	13.0	4.90	19.8	LONG

The TC insert is a self-tapping insert with a solid body. The tapping function is aided by the cutting flutes on the external thread. These inserts can be used in a variety of materials and are double ended to speed up assembly times.

Material: Brass

Headed Screw Fit (Soft Thermoplastic)

Series: 20130 Type: D

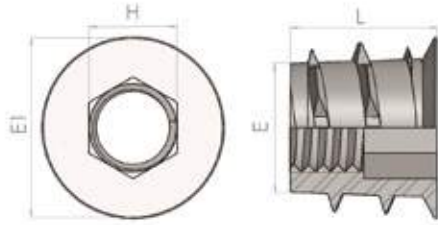

Information is for guidance only and subject to change.

Part No	Thread	L	Hole	E	E1	H
M410	M4	10.0	5.7 / 6.0	5.5	7.8	4.0
M507	M5	7.0	7.7 / 8.0	7.1	11.5	5.0
M510	M5	10.0	7.7 / 8.0	7.1	11.5	5.0
M513	M5	13.0	7.7 / 8.0	6.6	11.5	5.0
M520	M5	20.0	7.7 / 8.0	7.0	11.5	5.0
M610	M6	10.0	8.7 / 9.0	8.0	12.5	6.0
M613	M6	13.0	8.7 / 9.0	7.5	12.5	6.0
M616	M6	16.0	8.7 / 9.0	7.5	12.5	6.0
M620	M6	20.0	8.7 / 9.0	7.5	12.5	6.0
M625	M6	25.0	8.7 / 9.0	8.0	12.5	6.0
M813	M8	13.0	10.7 / 11.0	9.5	14.5	8.0
M820	M8	20.0	10.7 / 11.0	9.5	14.5	8.0
M825	M8	25.0	10.7 / 11.0	9.5	14.5	8.0
M1013	M10	13.0	12.2 / 12.25	11.5	16.0	10.0
M1025	M10	25.0	12.2 / 12.25	11.5	16.0	10.0

Type D Inserts are die cast, self-tapping inserts with a hexagon drive. The coarse thread makes them ideal for soft materials. The thin head provides a large surface area and will screw flush with the material surface.

Material: Zamac

Finish: Zinc & Clear Passivate

Screw Fit (Soft Thermoplastic)

Series: 20131 Type: E

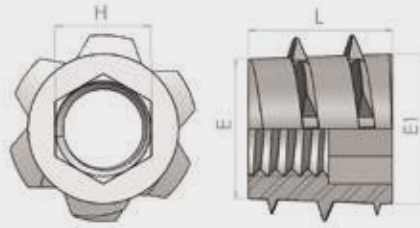

Information is for guidance only and subject to change.

Part No	Thread	L	Hole	E	E1	H
M410	M4	10.0	5.7 / 6.0	5.5	7.3	4.0
M513	M5	13.0	7.7 / 8.0	6.7	10.9	5.0
M610	M6	10.0	8.7 / 9.0	7.5	12.0	6.0
M613	M6	13.0	8.7 / 9.0	7.5	11.5	6.0
M620	M6	20.0	8.7 / 9.0	7.7	11.7	6.0
M813	M8	13.0	10.7 / 11.0	9.5	14.2	8.0
M820	M8	20.0	10.7 / 11.0	9.5	14.3	8.0
M825	M8	25.0	10.7 / 11.0	10.5	14.3	8.0

Type E Inserts are die cast, self-tapping inserts with a hexagon drive. The coarse thread makes them ideal for soft materials. They have no head allowing them to be screwed below the surface of the material.

Material: Zamac

Finish: Zinc & Clear Passivate



Heat / Ultrasonic Fit (Thermoplastic)

Series: 20106 Type: IS

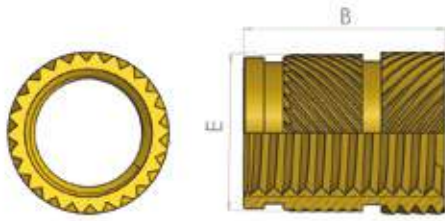

Information is for guidance only and subject to change.

Part No	Thread	Ext. Diam. E	Length B	Hole dia. L+0.1	Min Wall W
ISO20H040	M2	3.6	4.0	3.2	2.0
ISO25H040	M2.5	4.6	4.0	4.0	2.3
ISO25H058	M2.5	4.6	5.8	4.0	2.3
ISO30H040	M3	4.6	4.0	4.0	2.3
ISO30H058	M3	4.6	5.8	4.0	2.3
ISO35H058	M3.5	5.4	5.8	4.8	2.5
ISO35H072	M3.5	5.4	7.2	4.8	2.5
ISO40H047	M4	6.3	4.7	5.6	2.5
ISO40H058	M4	6.3	5.8	5.6	2.5
ISO40H082	M4	6.3	8.2	5.6	2.5
ISO50H082	M5	7.0	8.2	6.4	2.7
ISO50H095	M5	7.0	9.5	6.4	2.7
ISO60H095	M6	8.6	9.5	8.0	3.0
ISO60H127	M6	8.6	12.7	8.0	3.0
ISO80H095	M8	10.2	9.5	9.6	3.5
ISO80H127	M8	10.2	12.7	9.6	3.5
IS100H095	M10	12.3	9.5	11.9	4.0
IS100H127	M10	12.3	12.7	11.9	4.0

The IS range of inserts can be installed with heat or ultrasonics. They are designed to provide strong, reusable thread forms in Thermoplastic materials. The unique opposing helix knurl provides exceptional resistance to torque and tensile (pull out) loads. They are suitable for all thermoplastics.

Material: Brass

Stainless steel or nickel plated available by special order.

Headed Heat / Ultrasonic Fit (Thermoplastic)

Series: 20106 Type: HIS

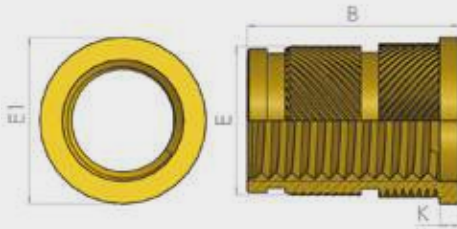

Information is for guidance only and subject to change.

Part No	Thread	E	E1	K	B	Hole +0.1	Min Wall
HISO20H046	M2	3.6	4.8	0.6	4.6	3.2	2.0
HISO25H064	M2.5	4.6	5.6	0.6	6.4	4.0	2.3
HISO30H064	M3	4.6	5.6	0.6	6.4	4.0	2.3
HISO35H080	M3.5	5.4	6.4	0.8	8.0	4.8	2.5
HISO40H090	M4	6.3	7.2	0.8	9.0	5.6	2.5
HISO50H105	M5	7.0	8.0	1.0	10.5	6.4	2.7
HISO60H140	M6	8.6	9.5	1.3	14.0	8.0	3.0
HISO80H140	M8	10.2	11.0	1.3	14.0	9.6	3.5
HIS100H140	M10	12.3	14.0	1.3	14.0	11.9	4.0

The HIS range of inserts can be installed with heat or ultrasonics. They are designed to provide strong, reusable thread forms in Thermoplastic materials. The unique, diametrically opposing helix knurls create the herringbone pattern which provides exceptional resistance to torque loads and facilitates the flow of plastic into the two recessed grooves, providing greater pull out loads than alternative designs. This headed version provides a larger clamping surface to prevent jack out.

Material: Brass

Stainless steel or nickel plated available by special order.

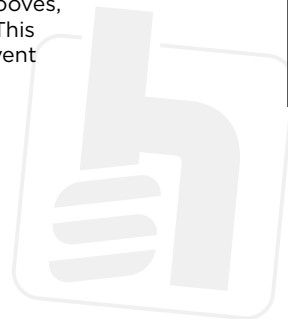

Heat Fit (Brittle Thermoplastic)

Series: 20108 Type: HL

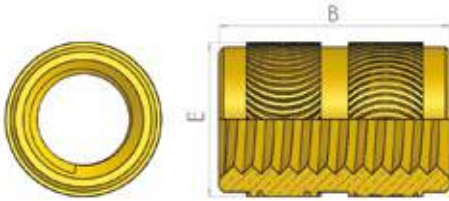

Information is for guidance only and subject to change.

Part No	Thread	E	B	Hole +0.1	Min Wall
HL020H040	M2	3.5	4.0	3.2	1.5
HL025H058	M2.5	4.4	5.8	4.0	1.8
HL030H058	M3	4.4	5.8	4.0	1.8
HL035H072	M3.5	5.2	7.2	4.8	2.2
HL040H082	M4	6.0	8.2	5.6	2.5
HL050H095	M5	6.8	9.5	6.4	3.0
HL060H127	M6	8.4	12.7	8.0	3.5
HL080H127	M8	10.0	12.7	9.6	4.5
HL100H127	M10	12.3	12.7	11.9	5.5

HL inserts provide a strong female threaded fixing in Polycarbonate and other “notch sensitive” brittle materials. These plastics often suffer from stress fractures from screws or inserts with sharp edges causing “hoop stress”. The specially designed knurl has no sharp edges which reduce the possibility of hoop stress.

Material: Brass

Heat Fit Double Ended (Thermoplastic)

Series: 20108 Type: TC



Information is for guidance only and subject to change.

Part No	Thread	E	B	Hole +0.1	Min Wall
TC020H040	M2	3.5	4.0	3.2	1.3
TC025H058	M2.5	4.4	5.7	4.0	1.6
TC030H057	M3	4.4	5.7	4.0	1.6
TC035H071	M3.5	5.2	7.1	4.8	1.8
TC040H082	M4	6.1	8.2	5.6	2.1
TC050H095	M5	6.8	9.5	6.4	2.6
TC060H127	M6	8.5	12.7	8.0	3.3
TC080H127	M8	10.0	12.7	9.6	4.5

The TC range of inserts are designed for heat or ultrasonic fitting into thermoplastic. They are double ended which eliminates the need for orientation making them ideal for automatic assembly machines when used in high volume applications.

Material: Brass



Moldcert Round Through Thread (Over Moulding)

Series: 20109 Type: DNT

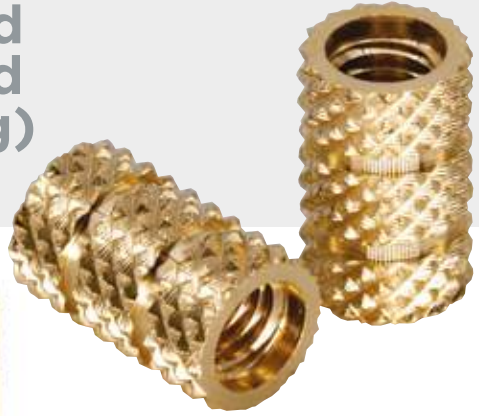
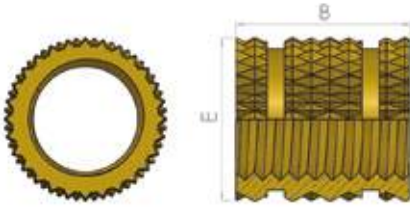

Information is for guidance only and subject to change.

Part No	Thread	E	B
DNT020H039	M2	3.4	3.92
DNT025H047	M2.5	4.15	4.72
DNT030H047	M3	4.15	4.72
DNT035H059	M3.5	5.0	5.87
DNT040H071	M4	5.9	7.12
DNT050H078	M5	6.6	7.82
DNT060H100	M6	9.25	9.92
DNT060H144	M6	9.25	14.40
DNT080H125	M8	11.5	12.47
DNT100H140	M10	13.9	13.97
DNT120H140	M12	16.3	13.97

The DNT range of inserts are designed for over moulding and can be used in all types of moulding processes. They are located on a plain pin in the mould tool and the large wall thickness allows the tool faces to clamp on either end providing a flush finish. The coarse knurl and grooves provide excellent rotational and pull out resistance.

Material: Brass

Moldcert Round Blind Thread (Over Moulding)

Series: 20109 Type: FT

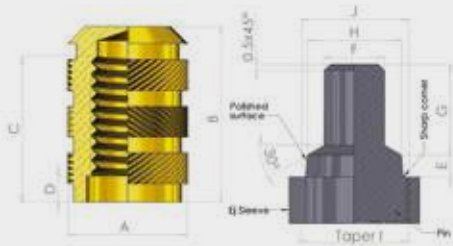

Information is for guidance only and subject to change.

Part No	Thread	A	B	C	D	E +/- 0.025	F - 0.025	G +/- 0.1	H +/- 0.0125	I Taper°	J
FT020H054	M2	3.4	5.5	3.6	1.0	0.80	1.55	2.65	2.300	6.0	3.0
FT025H063	M2.5	4.3	6.4	4.0	1.2	0.90	2.00	3.00	2.800	5.0	3.5
FT030H072	M3	4.7	7.3	4.6	1.3	1.05	2.45	3.40	3.125	4.5	4.0
FT035H090	M3.5	5.5	9.2	6.0	1.6	1.30	2.85	4.55	3.750	4.5	4.7
FT040H100	M4	6.3	10.2	6.7	1.8	1.55	3.25	5.00	4.425	4.5	5.4
FT050H110	M5	7.3	11.2	7.4	2.0	1.70	4.15	5.55	5.125	5.0	6.0
FT060H143	M6	9.8	14.4	8.1	2.0	1.80	4.95	6.15	6.600	5.5	8.0
FT080H160	M8	11.4	16.5	11.1	2.3	2.00	6.70	9.00	8.500	6.0	10.0
FT100H177	M10	13.8	17.9	11.9	2.4	2.10	8.40	9.70	10.500	6.0	12.0

FT Type inserts are designed for over moulding into thermoplastic or thermoset materials. The unique design of 3 herringbone knurl bands combined with the recesses offer excellent rotational and pull out performance. The open end has a counter bore which locates onto a shouldered pin within the tool to eliminate plastic ingress into the threads.

Material: Brass



Moldcert Hex Blind / Through Thread (Over Moulding)

Series: 20109 Type: HXT - HXB

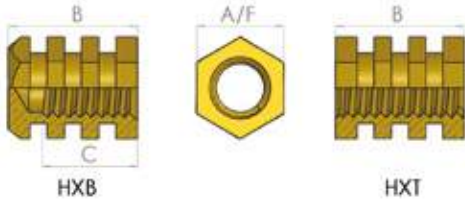

Information is for guidance only and subject to change.

Part No	Thread	A/F	B	C
HX_030905	M3	5.0	8.5	6.0
HX_040906	M4	6.0	8.5	6.0
HX_051008	M5	8.0	10.0	7.0
HX_051908	M5	8.0	19.0	15.0
HX_061510	M6	10.0	15.0	11.0
HX_061910	M6	10.0	19.0	15.0
HX_081912	M8	12.0	19.0	15.0
HX_101914	M10	14.0	19.0	15.0
HX_121914	M12	14.0	19.0	15.0
HX_141916	M14	16.0	19.0	15.0
HX_161918	M16	18.0	19.0	15.0

HXB and HXT Moldcerts are suitable for moulding into all types of plastic material during the moulding cycle. They are available with blind or through threads (HXB or HXT). The hexagon body gives very high torque resistance even in soft materials.

Material: Brass

Stainless Steel 303 (code SS) Special Order Only
Specials also available subject to MOQ and lead times.

Expansion Fit (Thermoset)

Series: 20110 Type: DMK

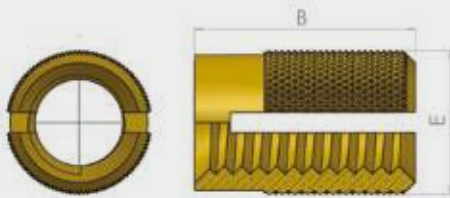

Information is for guidance only and subject to change.

Part No	Thread	E	B	Min Wall	Hole Dia
DMK020H040	M2	3.45	4.0	2.4	3.2 - 3.3
DMK025H048	M2.5	4.20	4.8	3.2	4.0 - 4.1
DMK030H048	M3	4.20	4.8	3.2	4.0 - 4.1
DMK035H064	M3.5	5.00	6.4	3.6	4.7 - 4.8
DMK040H080	M4	5.83	8.0	4.0	5.5 - 5.6
DMK050H095	M5	6.60	9.5	4.8	6.3 - 6.4
DMK060H127	M6	8.30	12.7	6.0	7.9 - 8.0
DMK080H127	M8	9.90	12.7	7.0	9.5 - 9.6

DMK inserts are designed to provide strong reusable threads in thermoset and other hard plastics. On installation, the insert collapses as it is pushed into the receiving hole. Insertion of the screw expands the sharp diamond points of the knurl into the surface of the hole and penetrates the plastic. This provides a high resistance to torque and pull out loads. They can also be used in solid and hardcore laminates.

Material: Brass



Reverse Headed Expansion Fit (Thermoset)

Series: 20110 Type: DMR

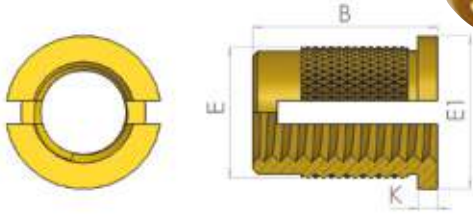

Information is for guidance only and subject to change.

Part No	Thread	E	B	E1	K	Min Wall	Hole Dia
DMR020H040	M2.0	3.45	4.00	4.80	0.60	2.40	3.2 - 3.3
DMR025H048	M2.5	4.20	4.80	5.60	0.60	2.80	4.0 - 4.1
DMR030H048	M3.0	4.20	4.80	5.60	0.60	3.20	4.0 - 4.1
DMR035H064	M3.5	5.00	6.40	6.40	0.80	3.60	4.7 - 4.8
DMR040H080	M4.0	5.85	8.00	7.20	0.80	4.00	5.5 - 5.6
DMR050H095	M5.0	6.60	9.50	8.00	1.00	4.80	6.3 - 6.4
DMR060H127	M6.0	8.30	12.70	9.50	1.30	6.00	7.9 - 8.0
DMR080H127	M8.0	9.90	12.70	11.00	1.30	6.00	9.5 - 9.6

DMR inserts are designed to provide strong reusable threads in thermoset and other hard plastics. On installation, the insert collapses as it is pushed into the receiving hole. Insertion of the screw expands the sharp diamond points of the knurl into the surface of the hole and penetrates the plastic. This provides a high resistance to torque and pull out loads. The DMR has a slot through the head. The screw is meant to enter the insert from the opposite side to the head. The head therefore gives additional resistance to pull-through loads.

Material: Brass

Headed Expansion Fit (Thermoset)

Series: 20110 Type: HDM

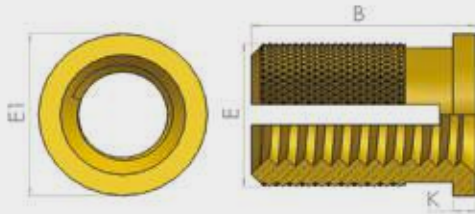

Information is for guidance only and subject to change.

Part No.	Thread	E	B	E1	K	Min Wall	Hole Dia
HDM020H040	M2	3.45	4.0	4.8	0.5	2.4	3.2
HDM025H048	M2.5	4.20	4.8	5.5	0.5	2.8	4.0
HDM030H048	M3	4.20	4.8	5.5	0.6	3.2	4.0
HDM035H064	M3.5	5.00	6.4	6.4	0.8	3.6	4.8
HDM040H080	M4	5.85	8.0	7.1	1.0	4.0	5.6
HDM050H095	M5	6.60	9.5	7.9	1.0	4.8	6.4
HDM060H126	M6	8.30	12.6	9.5	1.3	6.0	8.0
HDM080H126	M8	9.90	12.6	11.1	1.3	6.0	9.6

HDM inserts are designed to provide strong reusable threads in most plastics including thermoset. On installation, the insert collapses as it is pushed into the receiving hole. Insertion of the screw expands the sharp diamond points of the knurl into the surface of the hole and penetrates the plastic. This provides a high resistance to torque and pull-out loads. The HDM has a slot through the body, the screw is meant to enter the insert through the head. The head therefore gives additional resistance to jack out loads, where the through hole in the mating component is larger than the traditional smaller diameter, non-headed inserts.

Material: Brass



Press Fit Expansion (Thermoplastic)

Series: 20110 Type: PL

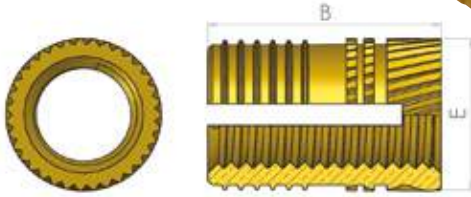

Information is for guidance only and subject to change.

Part No	Thread	E	B	Hole +0.1	Min Wall
PL020H040	M2	3.7	4.0	3.2	1.6
PL025H058	M2.5	4.5	5.8	4.0	2.0
PL030H058	M3	4.5	5.8	4.0	2.0
PL035H072	M3.5	5.3	7.2	4.8	2.4
PL040H082	M4	6.2	8.2	5.6	2.8
PL050H095	M5	6.9	9.5	6.4	3.2
PL060H127	M6	8.5	12.7	8.0	4.0
PL080H127	M8	10.1	12.7	9.6	4.8

The PL range of inserts provide a thread locking feature as the screw expands the insert although this does increase the driving torque of the screw. The knurled body provides high torque and pull out performance. They should be installed using a squeezing action to avoid damaging the boss and the screw must pass through the insert to ensure maximum expansion.

Material: Brass

Heat / Ultrasonic Stud (Thermoplastic)

Series: 20106 Type: ISS

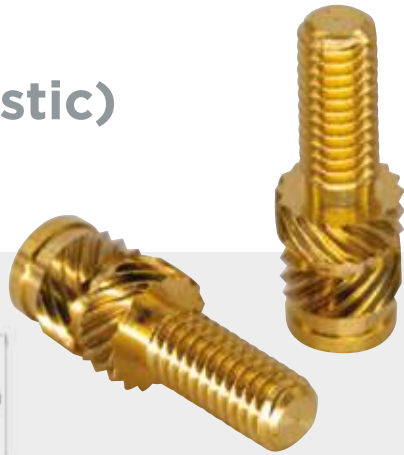

Information is for guidance only and subject to change.

Part No	Thread	E	B	S	Hole 0.1	Min Wall
ISS020L__	M2	3.6	4.0	6 - 16	3.2	2.0
ISS025L__	M2.5	4.6	5.8	6 - 16	4.0	2.3
ISS030L__	M3	4.6	5.8	6 - 16	4.0	2.3
ISS035L__	M3.5	5.4	7.2	6 - 25	4.8	2.5
ISS040L__	M4	6.3	8.2	6 - 25	5.6	2.5
ISS050L__	M5	7.0	9.5	6 - 25	6.4	2.7
ISS060L__	M6	8.6	12.7	6 - 25	8.0	3.0
ISS080L__	M8	10.2	12.7	10 - 25	9.6	3.5

The ISS range of inserts can be installed with heat or ultrasonics. They are designed to provide strong reusable male thread form in thermoplastic materials. The unique, diametrically opposing helix knurls create the herringbone pattern which provides exceptional resistance to torque & tensile loads compared to other designs.

Material: Brass



Headed Heat / Ultrasonic Stud (Thermoplastic)

Series: 20106 Type: HSS

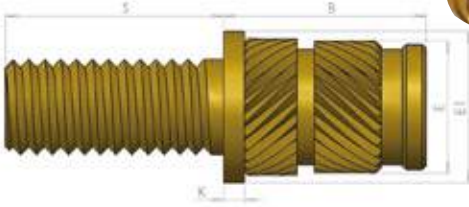

Information is for guidance only and subject to change.

Part No.	Thread	E	E1	K	B	S	Hole +0.1	Min Wall
HSS020L_	M2	3.6	4.8	0.6	4.6	6 - 16	3.2	2.0
HSS025L_	M2.5	4.6	5.6	0.6	6.4	6 - 16	4.0	2.3
HSS030L_	M3	4.6	5.6	0.6	6.4	6 - 16	4.0	2.3
HSS035L_	M3.5	5.4	6.4	0.8	8.0	6 - 25	4.8	2.5
HSS040L_	M4	6.3	7.2	0.8	9.0	6 - 25	5.6	2.5
HSS050L_	M5	7.0	8.0	1.0	10.5	6 - 25	6.4	2.7
HSS060L_	M6	8.6	9.5	1.3	14.0	6 - 25	8.0	3.0
HSS080L_	M8	10.2	11.0	1.3	14.0	10 - 25	9.6	3.5

The HSS range of inserts can be installed with heat or ultrasonics. They are designed to provide strong reusable male thread form in thermoplastic materials. The unique diametrically opposing helix knurls create the herringbone pattern which provides exceptional resistance to torque & tensile loads compared to other designs. This headed version provides a larger clamping surface to prevent jack out.

Material: Brass



Polyplast 30 Thread Forming Screw PZ Drive (Thermoplastic)

Series: 20210

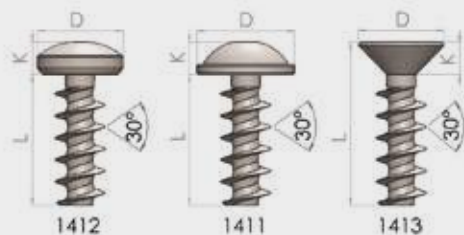

Information is for guidance only and subject to change.

Code	Thread Ø	1412		1411		1413	
		D	K	D	K	D	K
KB22	2.2	3.9	1.5	4.4	1.6	3.8	1.30
KB25	2.5	4.4	1.7	5.0	1.8	4.7	1.75
KB30	3.0	5.3	2.0	6.0	2.1	5.5	2.05
KB35	3.5	6.1	2.5	7.0	2.4	7.3	2.80
KB40	4.0	7.0	2.7	8.0	2.5	8.4	3.25
KB50	5.0	8.8	3.4	10.0	3.2	9.3	3.40
KB60	6.0	10.5	4.0	12.0	4.0	11.3	3.80

Thread	5	6	8	10	12	14	16	18	20	25	30
KB22											
KB25											
KB30											
KB35											
KB40											
KB50											
KB60											

Legend	
	Usually Available From Stock
	Special Order Only



Polyplast30 Screws have a special thread profile with a 30° flank angle which has been proven to outperform any other thread form in plastic. Rather than cutting material away like traditional screws the substrate material flows between the flanks providing up to ten times reusability before loss of performance.

To Specify Use: Series/head code/thread/length/finish
e.g. 20210/1412/KB40/16/6

Material: Steel Zinc & Clear Passivate (Cr3) Code 6
Stainless Steel Self Colour Code S

Special sizes and finishes available subject to MOQ.

Polyplast 30 Thread Forming Screw TX Drive (Thermoplastic)

Series: 20210

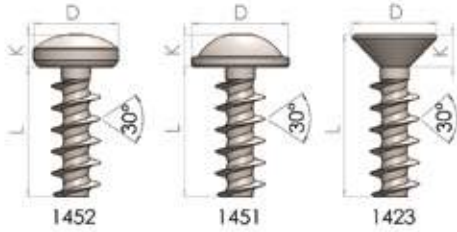

Information is for guidance only and subject to change.

Code	Thread Ø	1452		1451		1423	
		D	K	D	K	D	K
K22	2.2	4.0	1.5	4.5	1.4	3.8	1.30
K25	2.5	4.2	1.6	5.0	1.5	4.7	1.75
K30	3.0	5.6	2.1	6.0	2.1	5.5	2.05
K35	3.5	6.9	2.3	7.0	2.4	7.3	2.80
K40	4.0	7.5	2.6	8.0	2.6	8.4	3.25
K50	5.0	8.2	2.9	10.0	3.3	9.3	3.40
K60	6.0	10.8	3.8	12.0	3.6	11.3	3.80

Thread	5	6	8	10	12	14	16	18	20	25	30
K22											
K25											
K30											
K35											
K40											
K50											
K60											

Legend	
	Usually Available From Stock
	Special Order Only

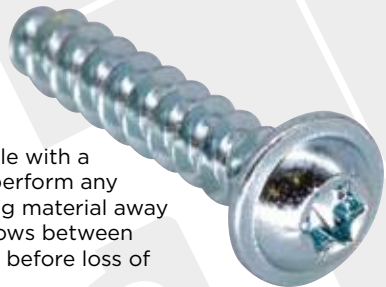

Polyplast30 Screws have a special thread profile with a 30° flank angle which has been proven to outperform any other thread form in plastic. Rather than cutting material away like traditional screws the substrate material flows between the flanks providing up to ten times reusability before loss of performance.

To Specify Use: Series/head code/thread/length/finish
e.g. 20210/1412/KB40/16/6

Material: Steel Zinc & Clear Passivate (Cr3) Code 6
Stainless Steel Self Colour Code S
Special sizes and finishes available subject to MOQ.

PN Rivet Nuts (All Materials)

Series: 30234 Type: PN

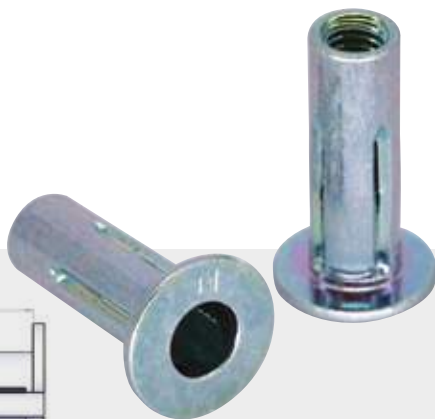
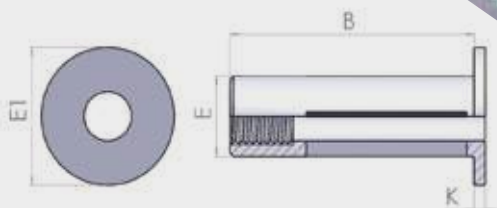

Information is for guidance only and subject to change.

Part No	Thread	Panel	E	E1	B	K	Hole
PN04P3.8	M4	0.5 - 3.8	6.12	11.1	16.7	0.96	6.13 - 6.25
PN04P6.9	M4	3.8 - 6.9	6.12	11.1	19.8	0.96	6.13 - 6.25
PN05P4.5	M5	0.5 - 4.5	7.47	12.7	21.0	0.96	7.48 - 7.62
PN05P8.1	M5	4.5 - 8.1	7.47	12.7	24.0	0.96	7.48 - 7.62
PN06P7.1	M6	0.5 - 7.1	8.79	15.9	25.4	1.5	8.80 - 8.93
PN06P12.7	M6	7.1 - 12.7	8.79	15.9	31.3	1.5	8.80 - 8.93
PN08P7.1	M8	0.5 - 7.1	11.1	19.0	29.0	1.57	11.11 - 11.50
PN08P12.7	M8	7.1 - 12.7	11.1	19.0	35.0	1.57	11.11 - 11.50
PN10P7.1	M10	0.5 - 7.1	13.06	22.2	31.0	2.24	13.07 - 13.26
PN10P12.7	M10	7.1 - 12.7	13.06	22.2	36.5	2.24	13.07 - 13.26

PN Nuts are a specialised rivet nut with a slotted body designed specifically for use in soft thin sheet materials. The slots enable the body to split into four arms at 90° in the setting process to provide a large load-bearing surface area and excellent pull-out performance. They have a very wide grip range making them suitable for a variety of applications.

Material: Mild Steel

Finish: Zinc Clear Passivate Cr3



JK Rivet Nuts (All Materials)

Series: 30235 Type: JK

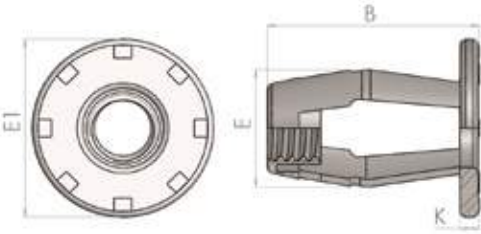

Information is for guidance only and subject to change.

Part No.	Thread	Panel	E	E1	B	K	Hole Dia
M04SN	M4	0 - 5.0	8.0	12.2	16.8	1.9	8.4
M04LN	M4	5.0 - 10.0	8.0	12.2	22.0	1.9	8.4
M05SN	M5	0 - 5.0	10.0	14.0	18.4	1.9	10.1
M05LN	M5	5.0 - 10.0	10.0	14.0	23.2	1.9	10.1
M06SN	M6	0 - 5.0	11.0	16.0	18.6	1.9	11.4
M06LN	M6	5.0 - 10.0	11.0	16.0	22.9	1.9	11.4



JK Nuts provide a captive female thread in all types of thin sheet materials. The wide panel range makes them very versatile, particularly in materials where the thickness can vary such as rotational mouldings. They are crimped with an air tool or a manual tool can also be used for small volume applications. Call our sales office for advice on the best tool.

Material: Mild Steel

Finish: Zinc Clear Passivate Cr3

Chimney & Lug Nuts

Series: 40114 - 40118

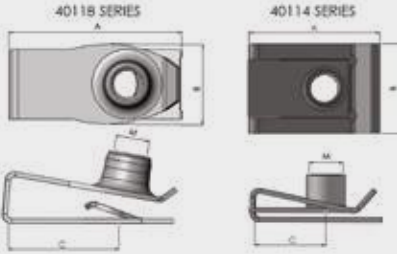
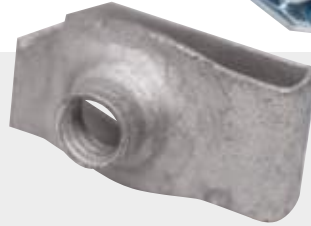

Information is for guidance only and subject to change.

Part No.	Thread M	A	B	C	Panel
40118 050019	M5	19	13	11.5	0.6-3.8
40118 060023	M6	23	14	13.5	0.8-4.0
40118 060023L	M6 LOCK	23	14	13.5	0.8-4.0
40118 080025	M8	24.5	16.5	14.5	0.8-4.0
40114 M4	M4	15	10	7.3	1.5-4.0
40114 M5	M5	20.5	14	10	0.5-4.0
40114 M6	M6	23.6	16	11	0.5-4.0
40114 M8	M8	24.3	17	13	0.5-4.0

Chimney and Lug Nuts offer a quick fastening solution for thin sheet materials. They clip over the panel edge or into a cut out profile to offer a strong female thread. Some sizes are available with a prevailing torque (self-locking) thread. The 40118 series are for heavier duty applications.

Material: Spring Steel C67S



HS1000 Heat Staking Machine

**Series: 14001 Type:
HS1000**



- **CE** Approved
- 240V supply
- Stakes inserts M1.4 - M8
- Easy to operate
- LED readout

Information is for guidance only and subject to change.

The HS1000 Heat Staking machine is designed to install HSL's range of threaded inserts with thread sizes between M1.4 and M8. The machine has a stroke of 55mm and an operating temperature of up to 400°C which is suitable for most applications. The temperature is easily set and monitored through the LED readout on the controller. The machine is more suited to low volume applications such as short production runs or prototype and development work. If you have a requirement for a fully automated installation machine please call our sales office for more information.

Other Products in Our Range



Sheet Metal Fasteners

We have an extensive range of fasteners for sheet metal applications. These include self-clinching nuts, studs and stand-offs, rivet nuts, rivet bushes and CD weld studs. Contact our sales office for our latest catalogue or download it from our website.



Spring Steel & Plastic Fasteners

Perfect for working with thin panels & trim in all materials, providing a quick and cost effective fastening solution. Our range of threaded and nonthreaded fasteners have numerous applications.



Compression Limiters

Compression Limiters are plain bushes used to reinforce bosses or mouldings when under high clamping loads. They can be over moulded or inserted after the moulding process. The combination of knurls and grooves in the body provide good retention in the moulding. They are manufactured in a range of materials and finishes to best suit the application and are usually made to order due to the variety of lengths and diameters.



Turned & Machined Components

Special turned parts can be made to your drawing or alternatively we can help develop new parts with the help of our in house design service which is covered by our ISO 9001:2015 quality approval. We work in all materials and manufacture small or large batch sizes. Our modern equipment produces the highest quality components at very competitive prices.

www.harrisonsilverdale.com



HARRISON
SILVERDALE LTD
INNOVATIVE FASTENERS

Harrison Silverdale Ltd

Unit 1, Traso Business Park
Callywhite Lane, Dronfield
Sheffield S18 2XR
United Kingdom



Certificate No. 01119

T: +44 (0) 1246 296 930

F: + 44 (0) 1246 296 940

fasteners@harrisonsilverdale.co.uk

making the **right** connection